

BLADE SIGN SUPPORT DETAIL
METAL STUDS w/ "HARD" EXTERIOR FINISH

DRUM SHADE SUPPORT DETAILS - OPEN WEB BAR JOISTS

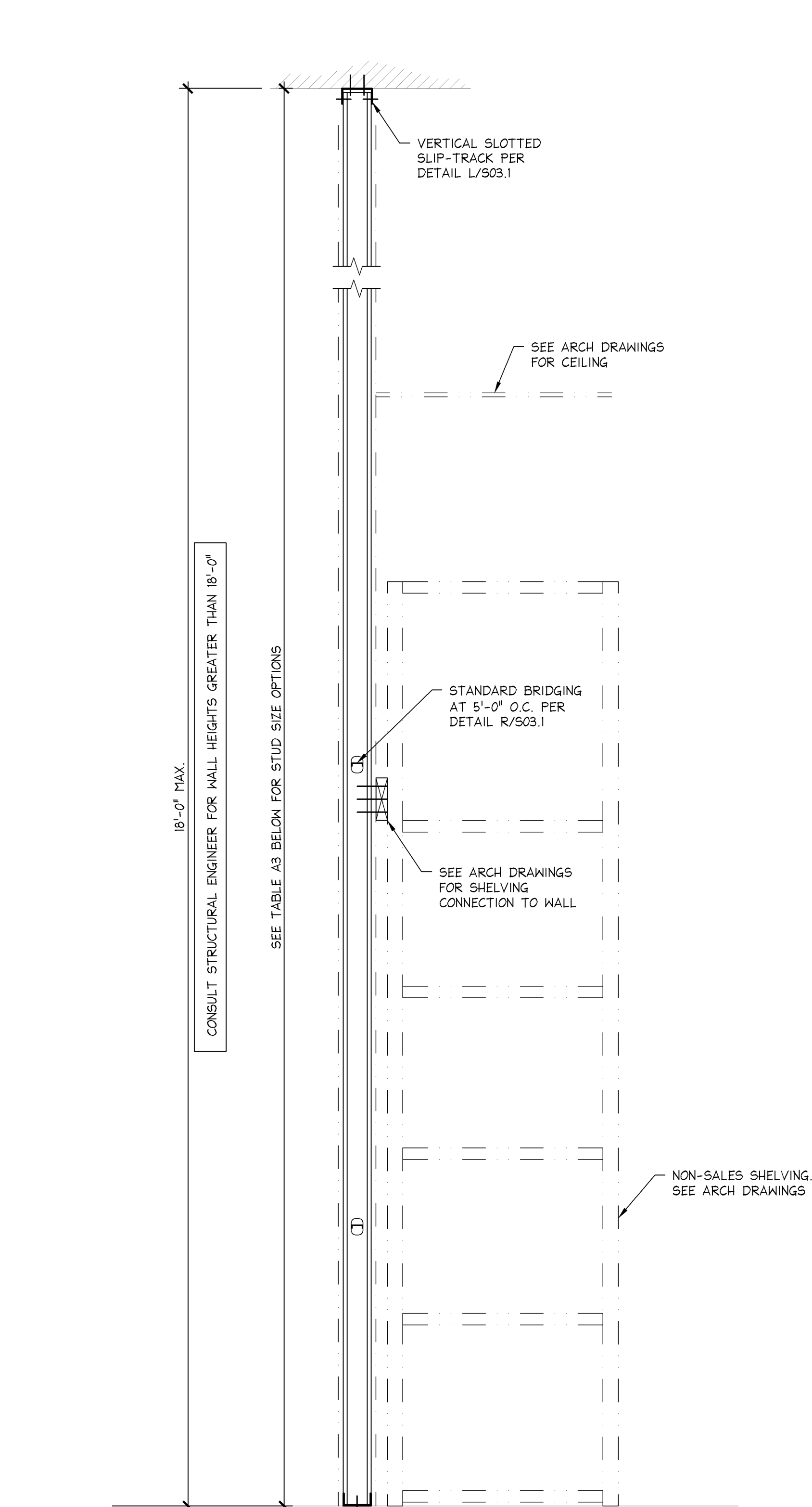

TABLE A3
STUD SIZE MATRIX FOR PARTITIONS THAT LATERALLY SUPPORT FLOOR MOUNTED STOCKROOM SHELVING

SEISMIC DESIGN CATEGORY C

STUD DESIGNATION	STUD DEPTH	FLANGE WIDTH	STUD GAUGE	STUD SPACING	MAXIMUM WALL HEIGHT
362S162-33	3 5/8"	1 5/8"	20	16"	18'-0"

NOTES:
REFER TO NOTES ON N/S01.01

FULL HEIGHT STUD WITHOUT DIAGONAL BRACING

WALL SECTIONS AT NON-SALES SHELVING
SEISMIC DESIGN CATEGORY C

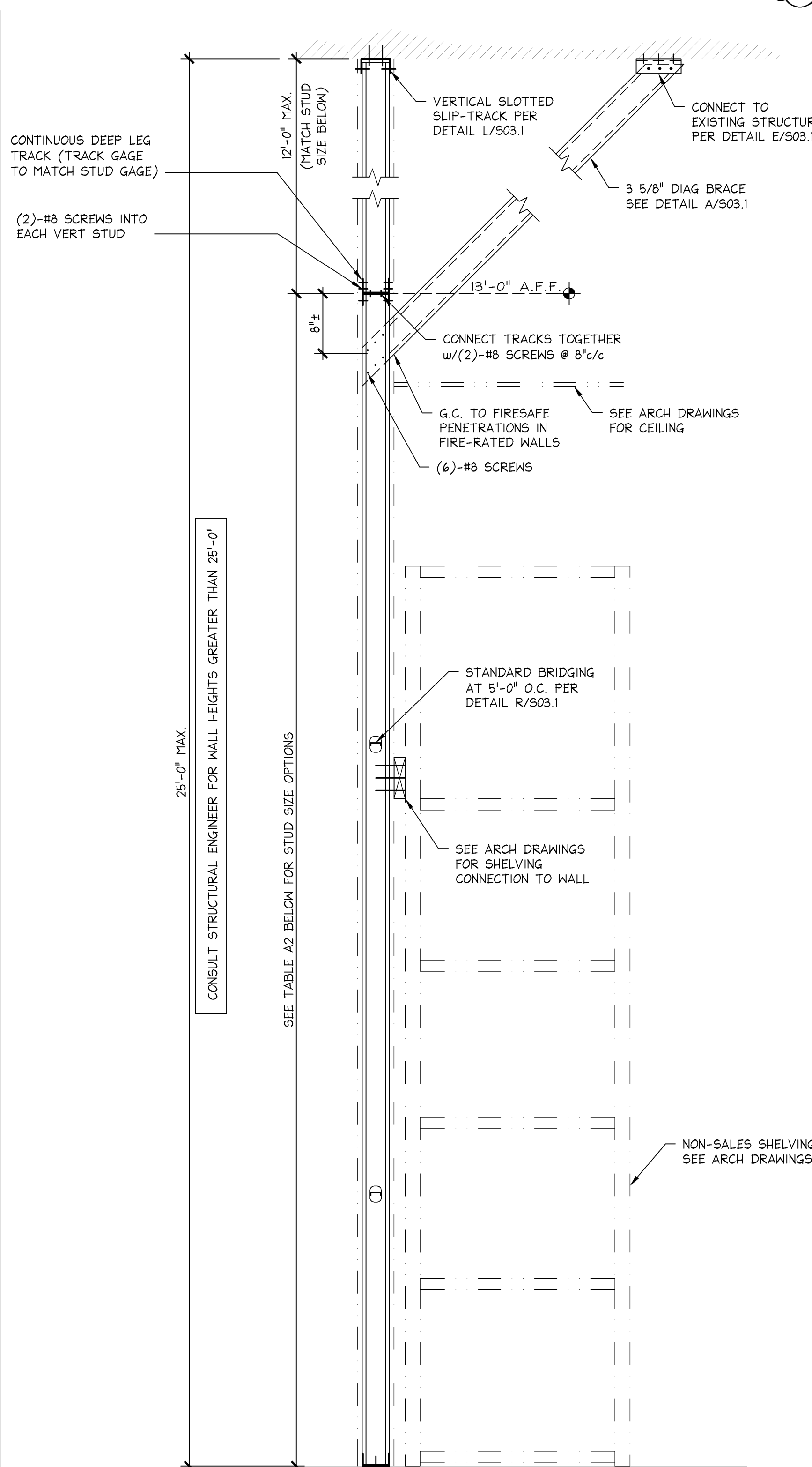

TABLE A2
STUD SIZE MATRIX FOR PARTITIONS THAT LATERALLY SUPPORT FLOOR MOUNTED STOCKROOM SHELVING

SEISMIC DESIGN CATEGORY C

STUD DESIGNATION	STUD DEPTH	FLANGE WIDTH	STUD GAUGE	STUD SPACING	MAXIMUM WALL HEIGHT TO DOUBLE TRACK
362S162-33	3 5/8"	1 5/8"	20	16"	13'-0"

NOTES:
REFER TO NOTES ON N/S01.01

FULL HEIGHT STUD WITH DIAGONAL BRACING

WALL SECTIONS AT NON-SALES SHELVING
SEISMIC DESIGN CATEGORY C

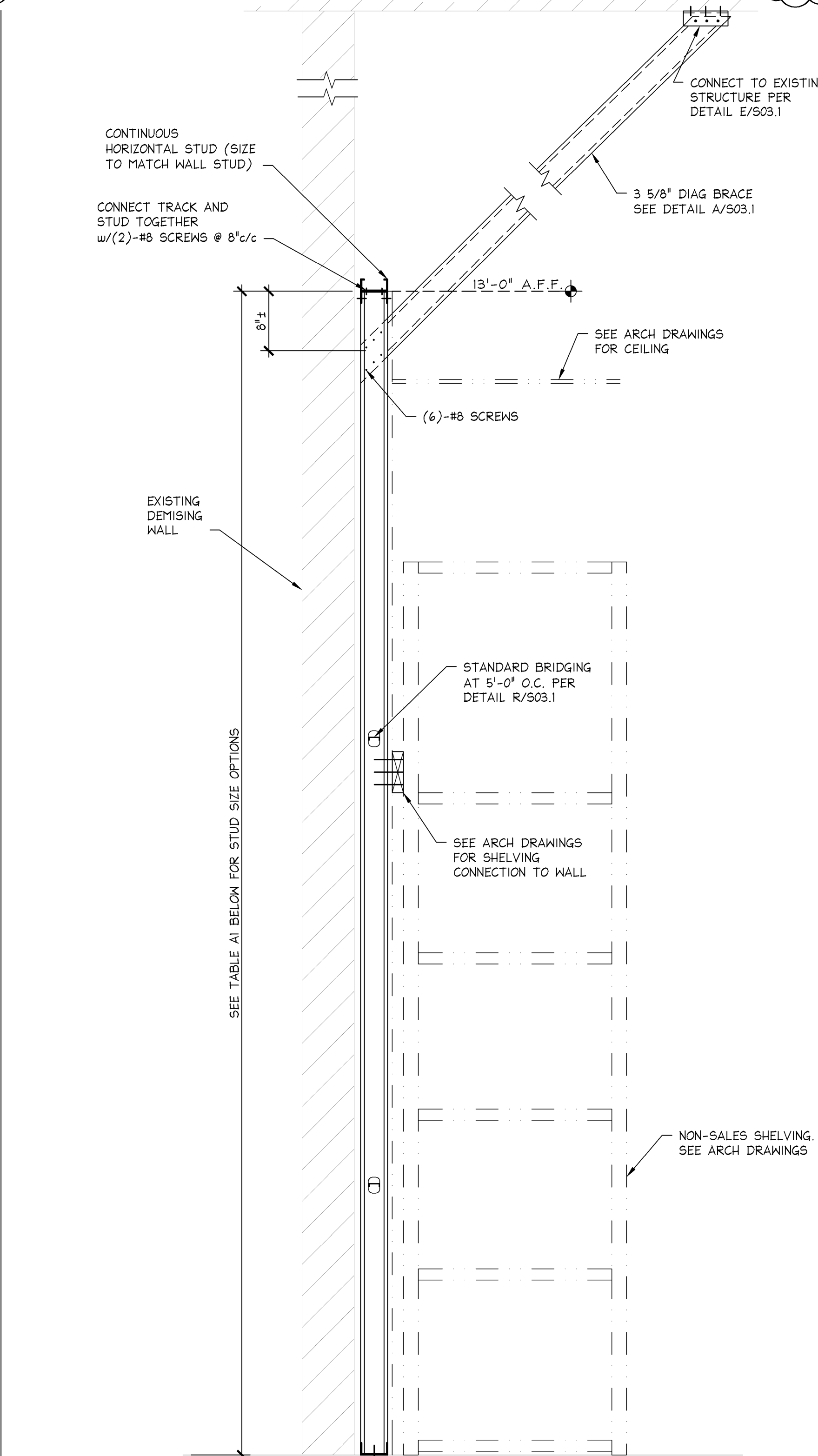

TABLE A1
STUD SIZE MATRIX FOR PARTITIONS THAT LATERALLY SUPPORT FLOOR MOUNTED STOCKROOM SHELVING

SEISMIC DESIGN CATEGORY C

STUD DESIGNATION	STUD DEPTH	FLANGE WIDTH	STUD GAUGE	STUD SPACING	MAXIMUM WALL HEIGHT
362S162-33	3 5/8"	1 5/8"	20	16"	13'-0"

NOTES:
REFER TO NOTES ON N/S01.01

PARTIAL HEIGHT STUD WITH DIAGONAL BRACING

WALL SECTIONS AT NON-SALES SHELVING
SEISMIC DESIGN CATEGORY C

SMBH
STORE DESIGN & CONSTRUCTION

Lbrands

Three Limited Parkway • Columbus, Ohio 43230
Telephone: 614.415.7000 • Fax: 614.415.7349

PROJECT INFORMATION:
010500587

VICTORIA'S SECRET
NORTH POINT MALL
SPACE #1030
1000 NORTH POINT CIRCLE
ALPHARETTA, GA 30022

REVISIONS:
REVISION 01
DATE: 01/02/2015

ELITE CONSTRUCTION GROUP
LANSING, MI 48203
PHONE: 979-285-0712
NOTE: THESE PRINTS HAVE BEEN REDUCED BY 50 PERCENT. SCALE WILL BE 50 PERCENT OF WHAT IS NOTED ON PLANS.

DATE ISSUED: 09/19/14
DESIGNED BY: LNF
DRAWN BY: AAO
CHECKED BY: JTB

WALL FRAMING AT NON-SALES SHELVING

DRAWING NUMBER:
S03.02

PROJECT INFORMATION:
010500587

VICTORIA'S SECRET
NORTH POINT MALL
SPACE #1030
1000 NORTH POINT CIRCLE
ALPHARETTA, GA 30022

REVISIONS:
REVISION 01
DATE: 01/02/2015

ELITE CONSTRUCTION GROUP
LANSING, MI 48203
PHONE: 979-285-0712
NOTE: THESE PRINTS HAVE BEEN REDUCED BY 50 PERCENT. SCALE WILL BE 50 PERCENT OF WHAT IS NOTED ON PLANS.

DATE ISSUED: 09/19/14
DESIGNED BY: LNF
DRAWN BY: AAO
CHECKED BY: JTB

WALL FRAMING AT NON-SALES SHELVING

DRAWING NUMBER:
S03.02

PROJECT INFORMATION:
010500587

VICTORIA'S SECRET
NORTH POINT MALL
SPACE #1030
1000 NORTH POINT CIRCLE
ALPHARETTA, GA 30022

REVISIONS:
REVISION 01
DATE: 01/02/2015

ELITE CONSTRUCTION GROUP
LANSING, MI 48203
PHONE: 979-285-0712
NOTE: THESE PRINTS HAVE BEEN REDUCED BY 50 PERCENT. SCALE WILL BE 50 PERCENT OF WHAT IS NOTED ON PLANS.

DATE ISSUED: 09/19/14
DESIGNED BY: LNF
DRAWN BY: AAO
CHECKED BY: JTB

WALL FRAMING AT NON-SALES SHELVING

DRAWING NUMBER:
S03.02